

Fast, affordable as-built packages with 3D virtual walkthroughs

Why choose us? You can trust our services for error-free site documentation.



Precise CAD floor plans & models

Capturing thousands of measurements per scan, each CAD floor plan and 3D model is accurate and available in various formats.



Property detail

Provides room measurements, dimensions and total square footage for space planning purposes, including renovation and fit-out projects.



3D immersive walkthrough

Virtually walk through a real-world space to view conditions and easily locate critical assets including MEP.



Measurement tool

Take custom measurements anytime and anywhere with the virtual walkthrough iGUIDE Viewer.



Real-time tagging

Identify equipment, features, and deficiencies as well as links, files or images.



Photos

Option to include still photos for additional documentation.

Our advantage

We know your plans need to be precise and you should be able to trust your partner.



Dedicated support

We'll work closely with you to understand your goals, timeline and scope.



Enhanced visualization

Use iGUIDE's comprehensive 3D virtual walkthroughs to communicate with your partners and vendors virtually.



Cost-effective solution

We offer competitive pricing, making high-precision as-built packages accessible for all commercial businesses.

iGUIDE®

Commercial Design Packages

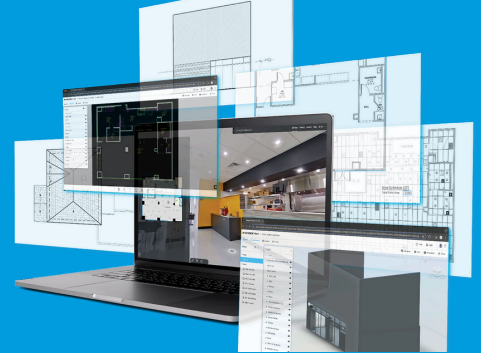

iGUIDE 3D CAD Package

Unlock a property's full potential. This package pairs iGUIDE's immersive experience with 2D CAD (DWG) and 3D Model (Revit) deliverables, detailed Plotted PDFs, plus a Roof Plan and Exterior Elevation Drawing to provide complete documentation of your property.

[Explore Sample](#)

Includes:

- 3D Virtual Walkthrough
- CAD Floor Plan
- 3D Model
- Plotted PDF
- Roof Plan
- Exterior Elevation Drawing
- Reflected Ceiling Plan (Optional)

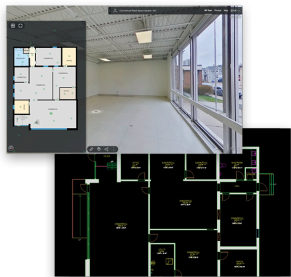

iGUIDE 2D CAD Package

Get the complete picture. This bundle combines iGUIDE's immersive tours with editable CAD Floor Plans (DWG files) and detailed Plotted PDFs for comprehensive property documentation and a jumpstart on your design process.

[Explore Sample](#)

Includes:

- 3D Virtual Walkthrough
- CAD Floor Plan
- Plotted PDF
- Reflected Ceiling Plan (Optional)



iGUIDE Premium Package

Provide an immersive virtual experience that lets partners, clients and contractors explore your site 24/7 from any location. Capture every detail and feature unique tagging and measurement tools, giving you comprehensive project information.

[Explore Sample](#)

Includes:

- 3D Virtual Walkthrough
- Schematic Floor Plan



iGUIDE RADIX Package

iGUIDE RADIX provides fast and efficient site visual documentation. The online interface with lidar point cloud is shareable and can be used to view a site and measure in 3D space.

[Explore Sample](#)

Includes:

- Point cloud-based
- 3D Virtual Walkthrough

